

# PIN RECEPTACLES

FOR .037" - .043" DIAMETER PINS

## 4314

4314-0-19-XX-18-XX-10-0

Wire crimp termination.  
Accepts wire sizes up to 24 AWG

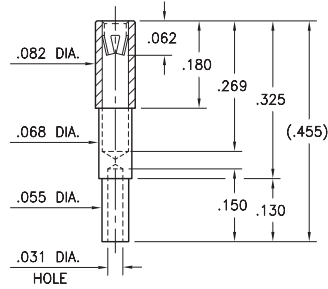

## 4401

4401-0-15-XX-18-XX-04-0

Press-fit in .079 mounting hole

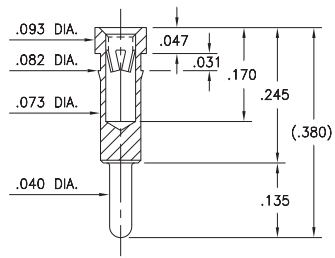

### SPECIFICATIONS:

**Shell Material:** Brass Alloy 360, 1/2 Hard

**Contact Material:** Beryllium Copper Alloy 172, HT

**Dimensions:** Inches

**Tolerances On:** Lengths: ±.005

Diameters: ±.002

Angles: ± 2°



**ORDER CODE:** XXXX - 0 - 15 - XX - 18 - XX - XX - 0

**BASIC PART #**

**SPECIFY SHELL FINISH:**

- 01 200 μ" TIN/LEAD OVER NICKEL
- ◆ 80 200 μ" TIN OVER NICKEL (RoHS)
- ◆ 15 10 μ" GOLD OVER NICKEL (RoHS)

**SPECIFY CONTACT FINISH:**

- 01 200 μ" TIN/LEAD OVER NICKEL
- ◆ 80 200 μ" TIN OVER NICKEL (RoHS)
- ◆ 27 30 μ" GOLD OVER NICKEL (RoHS)

**SELECT CONTACT:**

**#18 CONTACT (DATA ON PAGE 257)**

(For alternate contact choices, see group L on page 248)