

| REV. | DATE | ECR NO. | DESCRIPTION |
|------|----------|---------|-----------------|
| NC | 04/06/10 | XXXXXX | INITIAL RELEASE |

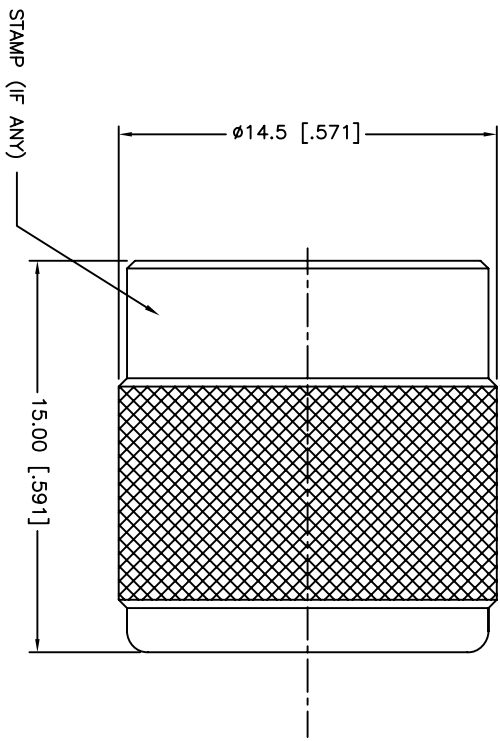

| QTY | FINISH | MATERIAL | DESCRIPTION |
|-----|--------|----------|-------------|
| 1 | RED | SILICONE | GASKET |
| 1 | NICKEL | BRASS | SHELL |

UNLESS OTHERWISE SPECIFIED, DIMENSIONS ARE IN INCHES AND FOR CUSTOMER REFERENCE ONLY.
 UNLESS OTHERWISE SPECIFIED, TOLERANCES FOR MILLIMETERS ARE:
 0.5 - 8mm ± 0.20mm
 8 - 30mm ± 0.40mm
 30 - 120mm ± 0.50mm
 UNLESS OTHERWISE SPECIFIED, TOLERANCES FOR INCHES ARE:
 .020 - .315 = ± 0.007"
 .315 - 1.180 = ± 0.015"
 1.180 - 4.724 = ± 0.020"
 DO NOT SCALE DRAWING

| APPROVALS | DATE |
|---------------|----------|
| DRAWN F. WANG | 04/06/10 |
| CHECKED | |
| ISSUED | |
| SHEET 1 OF 1 | |

Amphenol Connex

PART DESCRIPTION: TNC MALE CAP IP67 RATED

PART NO. 202101-12

DWG. NO. 202101-12.DWG

REV. NC

SIZE A

SCALE NA